

LED Down Light - 77

Data Specification:



Performance & parameter of product

Model No.	Part Number	OT7720-3W	OT7820-3W
Performance Parameter	Lamp	Warm white/Natural white/Cool white	
	Lumen (lm)	220lm/230lm/240lm	220lm/230lm/240lm
	Color temperature (K)	3000K/4200K/6500K	
	CRI	≥70	≥70
	Type of LED	COB LED	COB LED
	Beam angle	24°	24°
	Decay rate (%)	less than 3% within 1000 working hours	
	Total power (W)	3-4W	3-4W
	Lifespan (Hrs)	≥30000Hrs	≥30000Hrs
	High voltage testing	1750Vac/1min	1750Vac/1min
	LED parameter	Lighting efficiency	100LM/W
Chip quantity		15Pcs	15Pcs
Series-parallel way		3S5P	3S5P
Voltage		9-10.2VDC	9-10.2VDC
Current		300mA	300mA
Driver Parameter	Input parameter	100~240VAC , 50/60Hz	
	Power factor	0.5	0.5
	Output parameter	9-18VDC, 300mA	9-18VDC, 300mA
Structure Parameter	Material	Cast-Aluminium	Cast-Aluminium
	Dimension	Φ55*54mm	54*54*54mm
	Cut-out	Φ43mm	Φ43mm
	Protection class	calss I	calss I
	Ingress Protection	IP20	IP20
Environment Parameter	Application	Hotel,Home-lighting,Recreation place, Supermarket, Office building	
	Operating temperature	-25℃ ~ 50℃ 、 10% ~ 90% R.H.	
	Storage temperature	-30℃ ~ 85℃ 、 0% ~ 95% R.H.	
Packing Specification	Quantity NG/WG	20 Pcs	50 Pcs
	Carton size:		

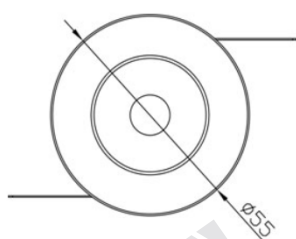

OT7720-3W

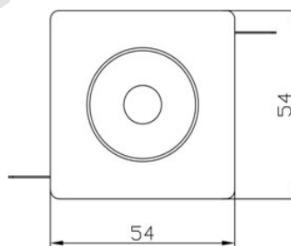
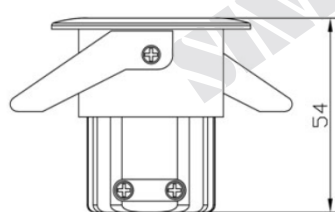

OT7820-3W

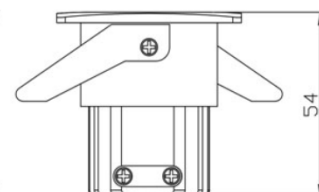

\* Others data not in the specification of data, please contact us.

如果你要求的規格參數不在本規格書裡表現出來請與我們聯絡。