

碳膜晶圓電阻

MELF MCF-Type
MELF Carbon Film Resistor

□ FEATURE

- ◆ Advanced thin film technology.
- ◆ Excellent overall stability: Class 0.25.
- ◆ Force fitted steel caps, tin plated on nickel barrier.
- ◆ Pure Sn termination on Ni barrier layer.
- ◆ Compatible with lead (Pb)-free and lead containing soldering processes.
- ◆ Lead (Pb)-free and RoHS compliant .

FIGURE



□ Applications

- ◆ Military
- ◆ Automotive
- ◆ Telecommunication
- ◆ Medical equipment.
- ◆ Avionics
- ◆ Space

□ CONSTRUCTION

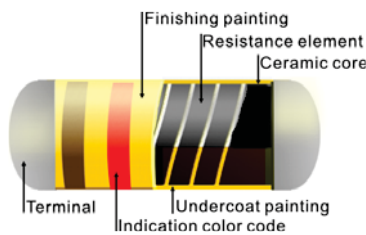

Coating Color: Beigge
Marking: Color Bands
* E-24 Series (3 Bands)

ORDERING INFORMATION

Example: VCSR04FD1R00

Power	Size	Type	Tolerance	TCR(°C)	Resistance	Packing
1/8W	0204	W-MCF04	J = ±5%	S=±5ppm	1R = 1R00	3K Reel
1/4WS	0204	V-MCF04	G = ±2%	B=±10ppm	10R=10R0	3K Reel
1/4W	0207	V-MCF07	F = ±1%	N=±15ppm	100R=100R	2K Reel
1/2WS	0207	U-MCF07		C=±25ppm	1K = 1001	2K Reel
1WSS	0207	S-MCF07		D=±50ppm	10K = 1002	2K Reel
				E=±100ppm	100K=1003	
					1M=1-004	

DIMENSION

Power	Size	Type	L	Φ D	L1	L2
1/8W	0204	W-MCF04	3.45 ±0.10	1.35 ±0.05	2.00 ±0.05	0.60 ±0.10
1/4WS	0204	V-MCF04	3.45 ±0.10	1.35 ±0.05	2.00 ±0.05	0.60 ±0.10
1/4W	0207	V-MCF07	5.90 ±0.20	2.20 ±0.15	3.40 ±0.10	1.00 ±0.10
1/2WS	0207	U-MCF07	5.90 ±0.20	2.20 ±0.15	3.40 ±0.10	1.00 ±0.10
1WSS	0207	S-MCF07	5.90 ±0.20	2.20 ±0.15	3.40 ±0.10	1.00 ±0.10

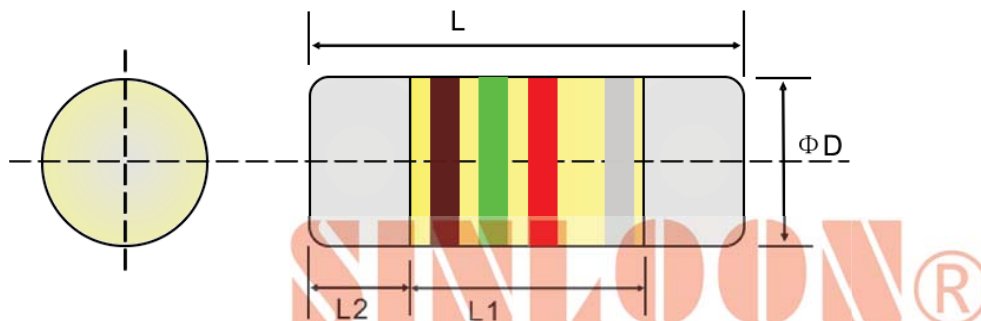

碳膜晶圓電阻

MELF MCF-Type
MELF Carbon Film Resistor

GENERAL ELECTRICAL SPECIFICATION

Type	Size	Power	Maximum Voltage		Resistance (Ω)	Tolerance (E-24)
			Working	Overload		
1/8W	0204	W-MCF04	200V	400V	10R ~ 2.2M	J = ±5%
1/4WS	0204	V-MCF04	250V	500V		
1/4W	0207	V-MCF07	250V	500V		
1/2WS	0207	U-MCF07	300V	600V		
1WSS	0207	S-MCF07	400V	600V		

* Mayloon is capable of manufacture the following option based on customer's requirement.

Characteristics

Item	Characteristics					Test Method	
	TCR (ppm/°C)		0 ~ 450	0 ~ 700	0 ~ 1000	0 ~ 1300	JIS-C-
1). Temperature Coefficient	0204	W-MCF04	Under 47K Ω	51K ~ 220K	240K ~ 470K	Over 510K	5202 5.2
	0204	V-MCF04					
	0207	V-MCF07	Under 100K Ω	110K ~ 1M	1.1M ~ 2.2M	Over 2.2M	
	0207	U-MCF07					
	0207	S-MCF07					
2). Short Time Overload	±(1%+0.05Ω)					5202 5.5	
3). Pulse Over Load	±(2%+0.05Ω)					5202 5.8	
4). Temperature Cycling	±(1%+0.05Ω)					5202 7.4	
5). Load Life In Humidity	±(5%+0.05Ω)					5202 7.9	
6). Load Life	±(5%+0.05Ω)					5202 7.10	
7). Resistance To Soldering Heat	±(2%+0.05Ω)					5202 6.4	
8). Solderability	90% Coverage/Min					5202 6.5	
9). Non-Combustibility	No Evidence of Flaming					UL-94 V-0	

POWER DERATING CURVE

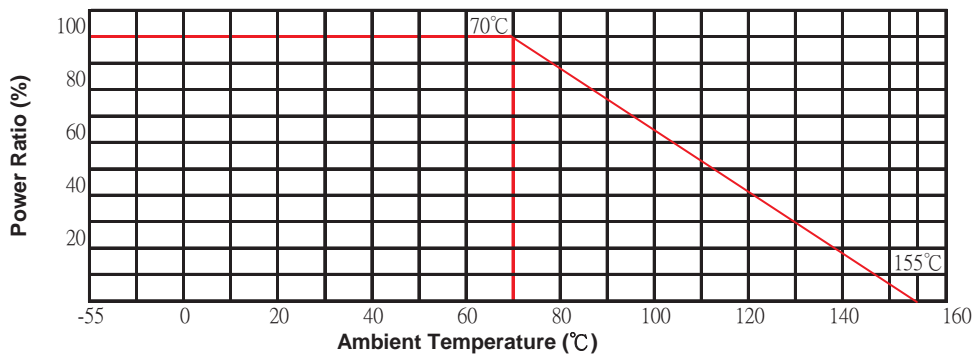



In case resistors operating ambient temperature in excess of the temperature range -55°C ~+155°C power ratio will be derated in accordance with the figure as shown on the right.



碳膜晶圓電阻

MELF Type
MELF Carbon Film Resistor

PACKAGE SPECIFICATION

Power	Size	Type	Quantity(ea)			  品質承諾標誌 QUALITY COMMITMENT
			Paper Reel Tape		In Box	
1/8W	0204	W-MCF04	3000 pcs	7" Reel	30K	180K pcs
1/4WS	0204	V-MCF04	3000 pcs	7" Reel	30K	180K pcs
1/4W	0207	V-MCF07	2000 pcs	7" Reel	20K	120K pcs
1/2WS	0207	U-MCF07	2000 pcs	7" Reel	20K	120K pcs
1WSS	0207	S-MCF07	2000 pcs	7" Reel	20K	120K pcs

TYPE	MELF MCF	
	0204	0207
SIZE		
W	8.00±0.10	12.00±0.10
P	4.00±0.10	4.00±0.10
E	1.75±0.10	1.75±0.10
F	3.50±0.05	5.50±0.05
P2	2.00±0.05	2.00±0.05
D	1.50±0.10	1.50±0.10
D1	1.00±0.10	1.50±0.10
Po	4.00±0.10	4.00±0.10
B	8.00±0.50	12.00±0.50
Ao	1.60±0.10	2.40±0.10
Bo	3.70±0.10	6.05±0.10
Ko	1.65±0.10	2.50±0.10
t	0.22±0.05	0.30±0.05

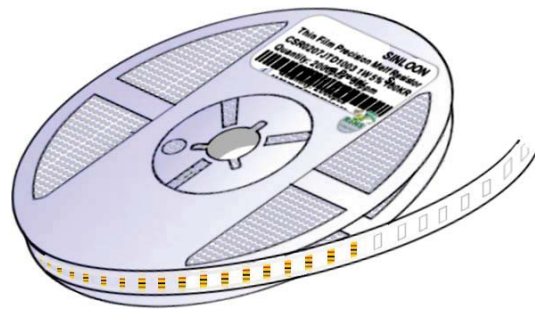
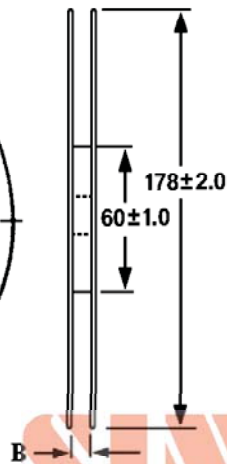
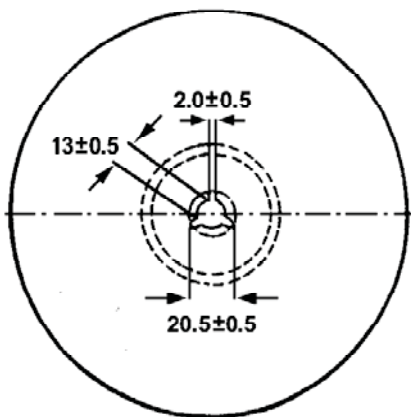
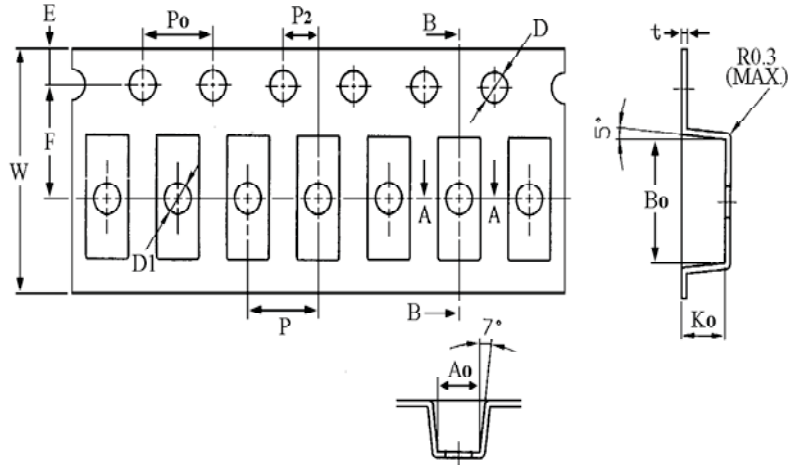

SINLOON®