

SINLOON®

貼片型橋式整流二極管

DF005S-DF10S

Current : 1.0A

Surface Mount Glass Passivated Bridge Rectifier

FEATURE:

- ◆ Glass Passivated Die Construction
- ◆ Low Forward Voltage Drop
- ◆ High Current Capability
- ◆ High Surge Current Capability
- ◆ Designed for Surface Mount Application
- ◆ Plastic Material - UL Recognition Flammability Classification 94V-0

Figure



MECHANICAL CHARACTERISTICS:

- ◆ Case: DF-S, Molded Plastic
- ◆ Weight: 0.38 Grams (approx)
- ◆ Marking: Body top
- ◆ Terminals: Plated leads solderable per MIL-STD-202, Method 208.
- ◆ Mounting: Position any
- ◆ Lead Free for Rohm / Lead free version and "LF" suffix to part number.

Electrical Symbol

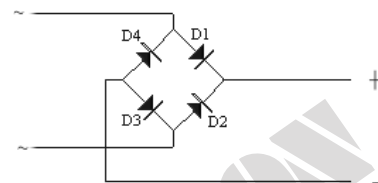

DIMENSION:

Unit:mm

DF-S		
Dim	Min	Max
A	7.8	8.5
B	6.2	6.5
C	0.2	0.35
D	0.076	0.33
E	---	10.4
G	1.02	1.53
H	8.13	8.8
J	2.2	2.5
K	5.0	5.2
L	1.0	1.2

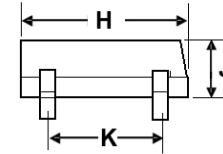
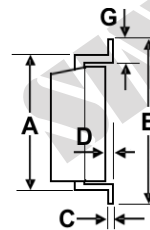
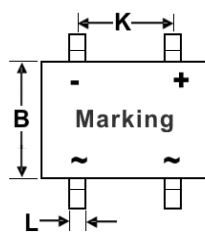

Maximum Ratings @ $T_A=25^\circ\text{C}$ unless otherwise specified

Single phase, half wave, 60Hz, resistive or inductive load, For capacitive load, derate current by 20%.

Characteristic	Symbol	DF							Unit
		005S	01S	02S	04S	06S	08S	10S	
Peak Repetitive Reverse Voltage	V_{RRM}								
Working Peak Reverse Voltage	V_{RWM}	50	100	200	400	600	800	1000	V
DC Blocking Voltage	V_R								
RMS Reverse Voltage	$V_{R(RMS)}$	35	70	140	280	420	560	700	V
Average Rectified Output Current @ $T_A=40^\circ\text{C}$	I_O	1.0							A
Non-Repetitive Peak Forward Surge Current 8.3ms single half sine-wave superimposed on Rated load (JEDEC Method)	I_{FSM}	50							A
Forward Voltage per element @ $I_F=40^\circ\text{C}$	V_{FM}	1.1							V
Peak Reverse Current @ $T_A=25^\circ\text{C}$	I_{RM}	5.0							μA
At Rated DC Blocking Voltage @ $T_A=125^\circ\text{C}$		500							
I^2t Rating for Fusing ($t<8.3\text{ms}$)	V_t^2	10							A^2s
Typical Junction Capacitance leg (note ¹)	C_J	25							pF
Typical Thermal Resistance per leg (note ²)	$R_{\theta JA}$	40							$^\circ\text{C/W}$
	$R_{\theta JL}$	15							
Operating and Storage Temperature Range	T_J, T_{STG}	-65 to +150							$^\circ\text{C}$

Note: 1. Measured at 1.0MHz and applied reverse voltage of 4.0VDC.
2. Mounted on PC Board with 13x13mm copper pad.

SINLOON®

貼片型橋式整流二極管

Current : 1.0A

DF005S-DF10S

Surface Mount Glass Passivated Bridge Rectifier

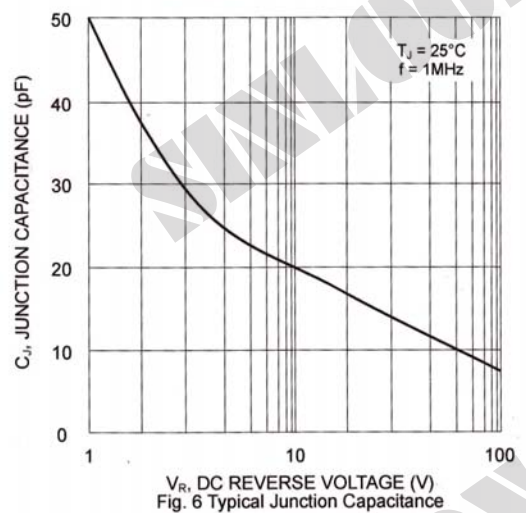
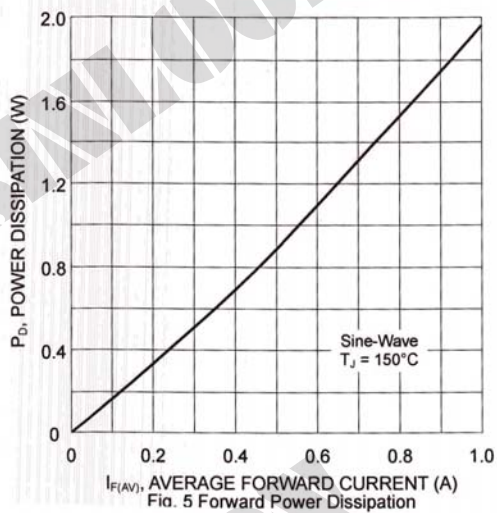
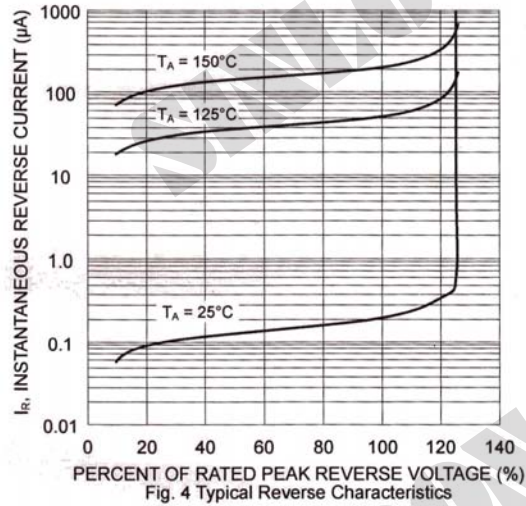
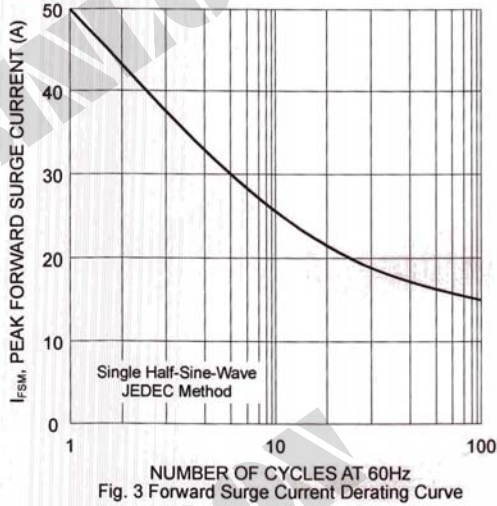
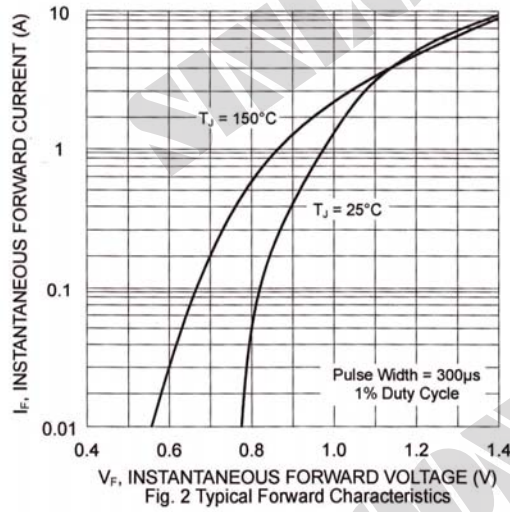
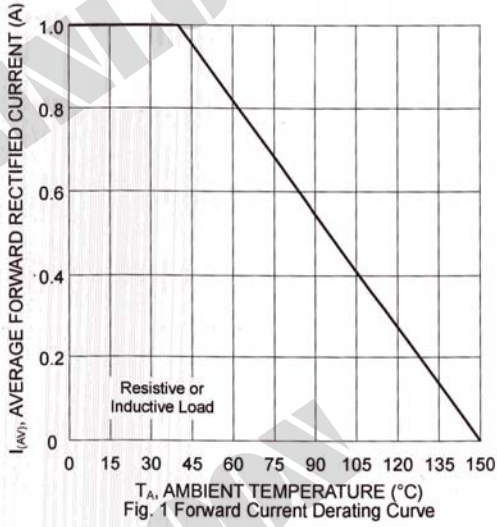

SINLOON®

貼片型橋式整流二極管

DF005S-DF10S

Current : 1.0A

Surface Mount Glass Passivated Bridge Rectifier

Marking Information

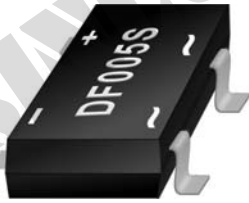

XX: Device Code see Table Page 1

Recommended Footprint

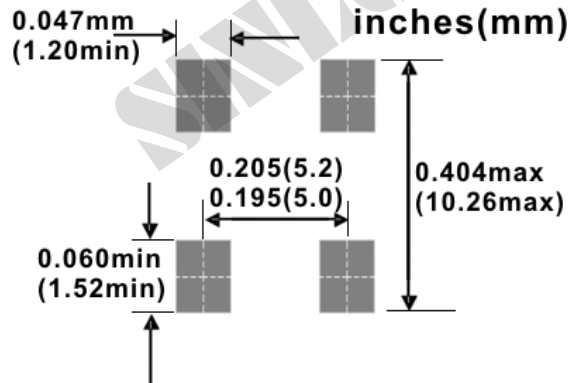

COMMON PACKING INFORMATION:

Reel Diameter (mm)	Quantity (Pcs)	Inner Box Size (mm)	Carton Size (mm)	Quantity	G/W
330	1500	L: 340 x W:337 x H: 45	L:370 x W:370 x H:420	24,000	17Kg

Note: 1. Anti-static or paper reel, blue or white color.
2. Components are packed in accordance with EIA standard 481-1 and 481-2.

Reel Diameter : Fig-1

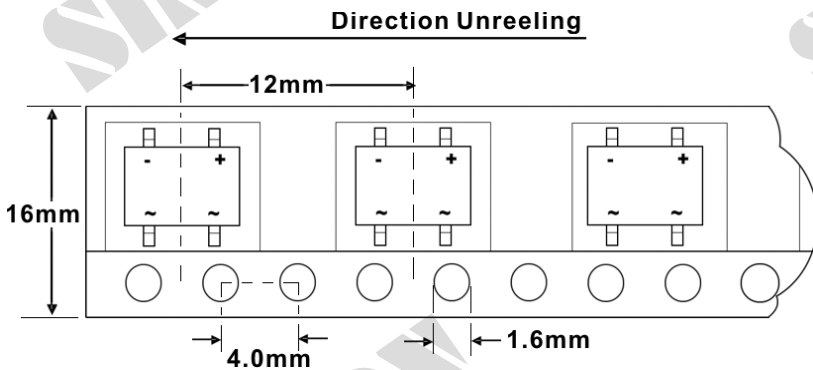
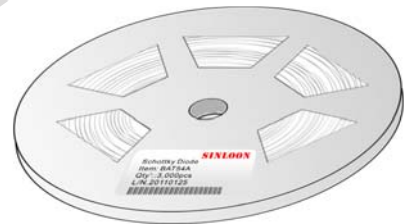

Fig-2



Carton Pack Fig-3



Inner Box: Fig-4



美隆電子產品規格特性參數的改變或更新不會另行通知。

Mayloon characteristic parameters of electronic product specification changes or updates without prior notice.